

Frame Assembly Instructions

- 1: If Frame Is Pre-Cut To Size, Skip To Step 4**
2: Measure And Cut Frame To Size.
 (See Samson How To Measure Instructions)

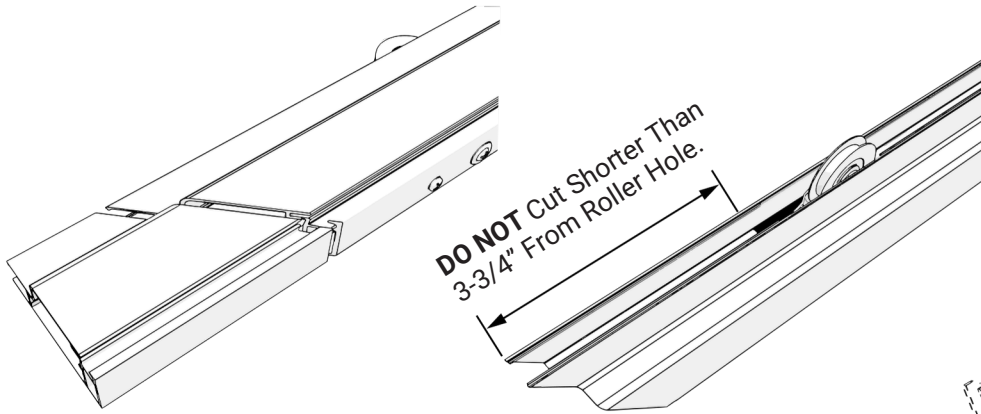

- 3: Using Drill Template, Drill Corner Key Holes at Each Mitered End.**

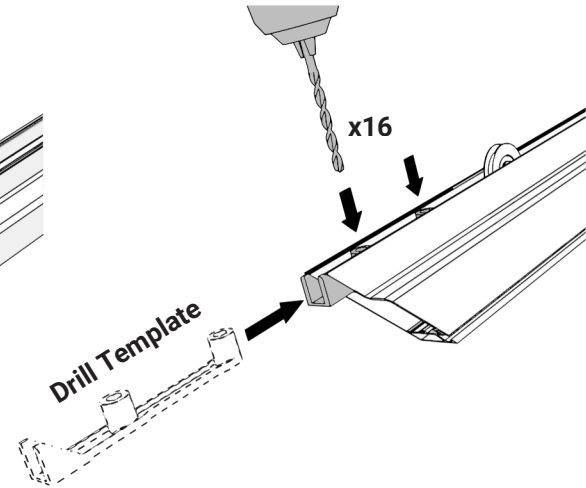

- 4: Slip Corner Keys In The Top and Bottom Rail**

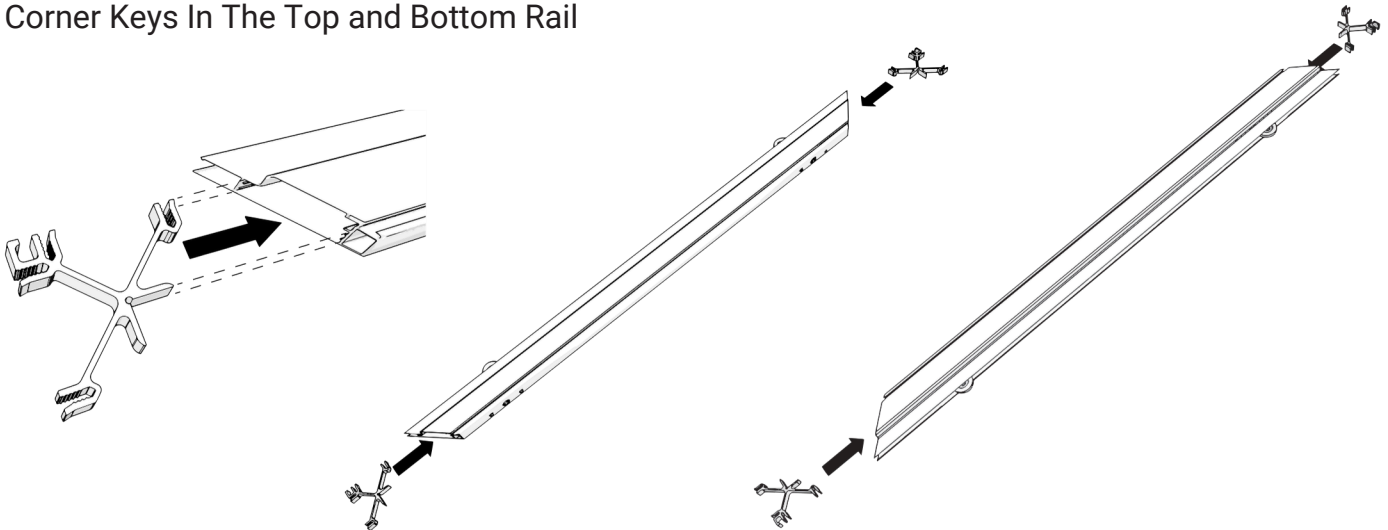

- 5: Complete Frame Assembly Using 10x1/2" Screws In Proper Order**

